

Bathroom Extras – data sheet set

This data sheet set includes:

- Basin wastes + bottle traps
- Bath wastes, bath waste kits + bath overflow kits

Contents

Basin wastes and bottle traps



p2



Pop-out Basin Waste
Colour options

PAGE 2



p4



Ceramic Pop-out Basin Waste
Colour options



p5

Pop-up Basin Waste
Chrome



p6



Bottle Trap
Colour options

Bath wastes, bath waste kits, bath overflow waste kits

Bath Waste Kits
Usage Guide
p 13



p7



Pop-out Bath Waste
Colour options

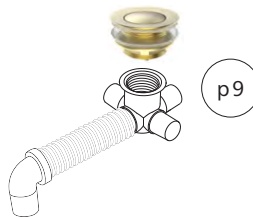

p9



FlexiWaste Bath Waste Pop-out Kit
Premium bath waste kit with pop-out waste
Colour options

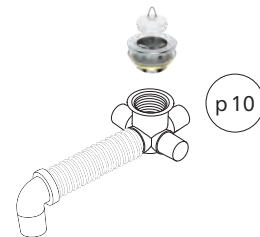

p10

FlexiWaste Bath Waste Kit Basic
Basic bath waste kit
Chrome plug and waste



p8

Bath Plug + Waste
Chrome, white rubber

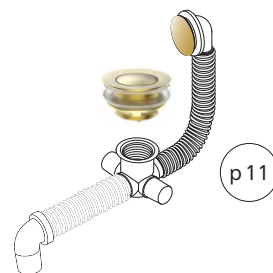

p11



FlexiWaste Bath Overflow Pop-out Kit
Premium overflow kit with pop-out waste
Colour options

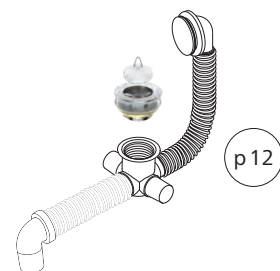

p12

FlexiWaste Bath Overflow Kit Basic
Basic bath overflow waste kit
Chrome plug and waste

SEIMA

kitchen + laundry + bathroom ware

seima.com.au

Please note

- All measurements are in millimetres.
- Use silicone sealant. Do not use epoxy type adhesives.
- Specifications may vary without notice as part of our continuous improvement practices.
- Clean with a damp cloth. Do not use abrasive cleaners, liquids or pastes.

Pop-out Basin Waste



Chrome



Brushed Nickel



Gunmetal



Brushed Gold



White Matte



Black Matte

POP OUT basin waste

- PULLS OUT!
- EASY CLEAN
- ANTI SEIZE
- ANTI CLOG



Innovative easy-to-remove pop-out design

Why pop-out?

The Pop-out waste does exactly what its name suggests — the top section of the waste simply pops out (or pulls out). This patented innovation has significant advantages including:

- **REMOVABLE** The top of the waste is completely removable. Easy access, easy cleaning.
- **ANTI CLOG** The ‘prongs’ on the top section of the waste are designed to catch debris (including hair) as it flows into the waste. The streamlined simplicity of this design makes it easy to keep clear and clean.
- **ANTI SEIZE** The pop-out design eliminates the possibility of the plug seizing in the waste.
- **OPEN DESIGN** The openness of the design promotes efficient drainage.
- **COMPATIBLE** with Lithos natural stone waste caps (supplied with Lithos basins).

More features

- **PREMIUM QUALITY** Durable, high quality finish — all components are premium quality.
- **SEIMA UNIVERSAL DESIGN** Suits 32 and 40 mm waste holes; suits overflow and non-overflow.

Order codes

| | |
|--------|--------------------------------------|
| 192010 | Pop-out Basin Waste — Chrome |
| 192012 | Pop-out Basin Waste — Brushed Nickel |
| 192199 | Pop-out Basin Waste — Gunmetal |
| 192013 | Pop-out Basin Waste — Brushed Gold |
| 192009 | Pop-out Basin Waste — White Matte |
| 192011 | Pop-out Basin Waste — Black Matte |

Compatible with natural stone waste caps supplied with natural stone basins. Simply screw off the metal cap and replace it with the natural stone cap.

Product details

WASTE OUTLET Universal. Suits 32 and 40 mm waste holes. Suits overflow and non-overflow.

FIXING Must be fitted by a licensed plumber. Warranty does not cover any fault caused by installation or part installation by an unlicensed person. Please refer to the diagram for installation guidelines. It is essential that the waste is sealed correctly using silicone where shown.

MATERIALS Solid brass base, plated/coated to achieve the colour finishes. The transparent flexible ring is premium quality.

CLEANING Clean with soapy water. Do not use corrosive or abrasive cleaners.

Easy to install



SEIMA

kitchen + laundry + bathroom ware

seima.com.au

Please note

- All measurements are in millimetres.
- Use silicone sealant. Do not use epoxy type adhesives.
- Specifications may vary without notice as part of our continuous improvement practices.
- Clean with a damp cloth. Do not use abrasive cleaners, liquids or pastes.

Pop-out Basin Waste – Installation Guide

Please refer to the diagram for specific guidelines.

- It is essential that the waste is sealed correctly using silicone where shown.
- Must be fitted by a licensed plumber. The Seima warranty does not cover any fault caused by installation or part installation by an unlicensed person.
- Clean with soapy water. Do not use corrosive or abrasive cleaners.

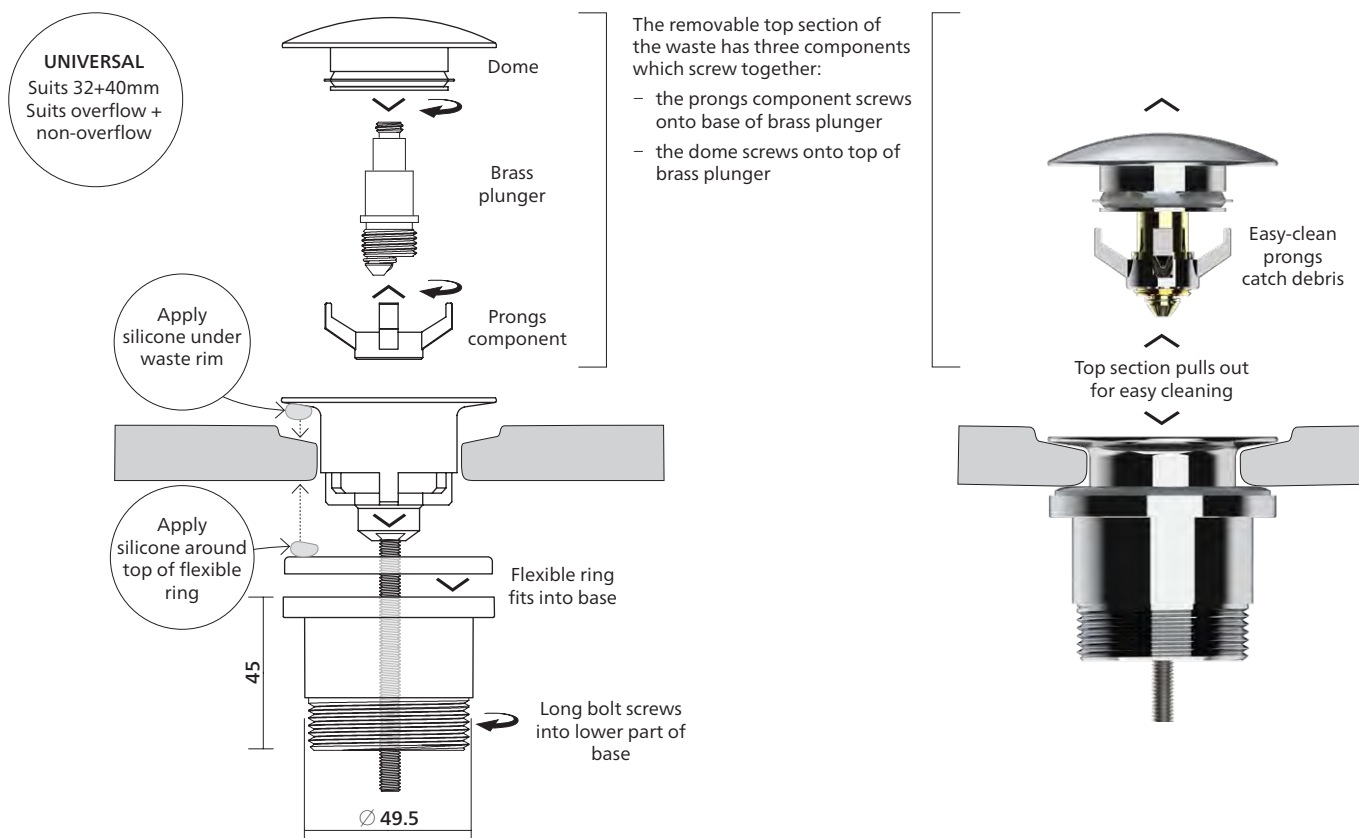

SEIMA

kitchen + laundry + bathroom ware

seima.com.au

Please note

- All measurements are in millimetres.
- Use silicone sealant. Do not use epoxy type adhesives.
- Specifications may vary without notice as part of our continuous improvement practices.
- Clean with a damp cloth. Do not use abrasive cleaners, liquids or pastes.

Ceramic Pop-out Basin Waste



POP[^]OUT

basin waste ceramic cap

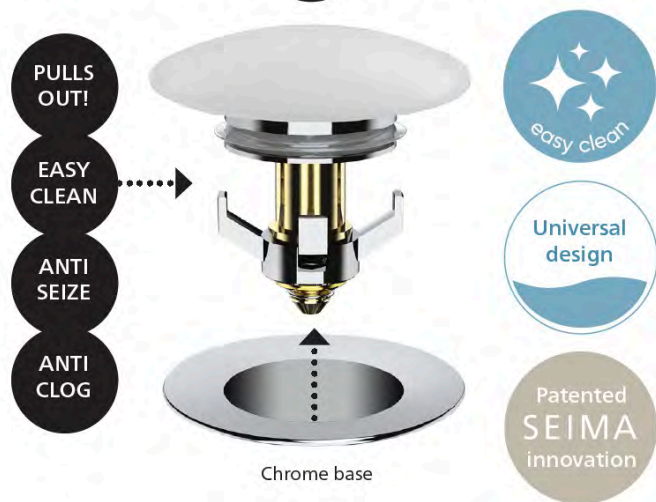

Ceramic waste cap and chrome pop-out base

Ceramic wastes offer a streamlined look for your ceramic basins. You can match the waste with your basin or choose a contrasting colour (eg black dome on white basin).

- The ceramic waste cap simply screws onto the pop-out base.
- Pop-out base has chrome finish.

Innovative easy-to-remove pop-out design

Why pop-out?

The Pop-out waste does exactly what its name suggests — the top section of the waste simply pops out (or pulls out). This patented innovation has significant advantages including:

- **REMOVABLE** The top of the waste is completely removable. Easy access, easy cleaning.
- **ANTI CLOG** The 'prongs' on the top section of the waste are designed to catch debris (including hair) as it flows into the waste. The streamlined simplicity of this design makes it easy to keep clear and clean.
- **ANTI SEIZE** The pop-out design eliminates the possibility of the plug seizing in the waste.
- **OPEN DESIGN** The openness of the design promotes efficient drainage.

More features

- **PREMIUM QUALITY** Durable, high quality finish — all components are premium quality.
- **SEIMA UNIVERSAL DESIGN** Suits 32 and 40 mm waste holes; suits overflow and non-overflow.

Order codes

| | |
|--------|---|
| 192257 | Ceramic Pop-out Basin Waste, White Silk Matte |
| 192258 | Ceramic Pop-out Basin Waste, White Gloss |
| 192259 | Ceramic Pop-out Basin Waste, Black Silk Matte |
| 192260 | Ceramic Pop-out Basin Waste, Rose Quartz |
| 192261 | Ceramic Pop-out Basin Waste, Smoky Taupe |
| 192262 | Ceramic Pop-out Basin Waste, Winter Sea |
| 192263 | Ceramic Pop-out Basin Waste, Forest |

Product details

| | |
|--------------|--|
| WASTE OUTLET | Universal. Suits 32 and 40 mm waste holes. Suits overflow and non-overflow. |
| FIXING | Must be fitted by a licensed plumber. Warranty does not cover any fault caused by installation or part installation by an unlicensed person. Please refer to the diagram for installation guidelines. It is essential that the waste is sealed correctly using silicone where shown. |
| MATERIALS | Solid brass base, chrome plated. Ceramic cap. |
| CLEANING | Clean with soapy water. Do not use corrosive or abrasive cleaners. |



SEIMA

kitchen + laundry + bathroom ware

seima.com.au

Please note

- All measurements are in millimetres.
- Use silicone sealant. Do not use epoxy type adhesives.
- Specifications may vary without notice as part of our continuous improvement practices.
- Clean with a damp cloth. Do not use abrasive cleaners, liquids or pastes.

Pop-up Basin Waste



Button design, chrome finish, universal

Order codes

| | | |
|--------|--|---------------------|
| 191825 | Button pop-up waste, chrome, PVC base | Old code: SVA-050 |
| 191826 | Button pop-up waste, chrome, chrome base | Old code: SVA-050-B |

Usage note

Pop-up wastes have a choice of base material, depending on the use. The PVC base is for general use. The metal base (chrome) is designed for use with a bottle trap.

Product details

WASTE OUTLET Universal, suits 32 and 40 mm waste holes, suits overflow and non-overflow.

FIXING Must be fitted by a licensed plumber. Warranty does not cover any fault caused by installation or part installation by an unlicensed person.

Refer to the diagram below for installation guidelines.

MATERIALS Chrome plated solid brass. PVC base or metal base.

CLEANING Clean with soapy water. Do not use corrosive or abrasive cleaners.

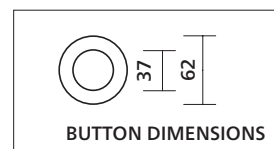
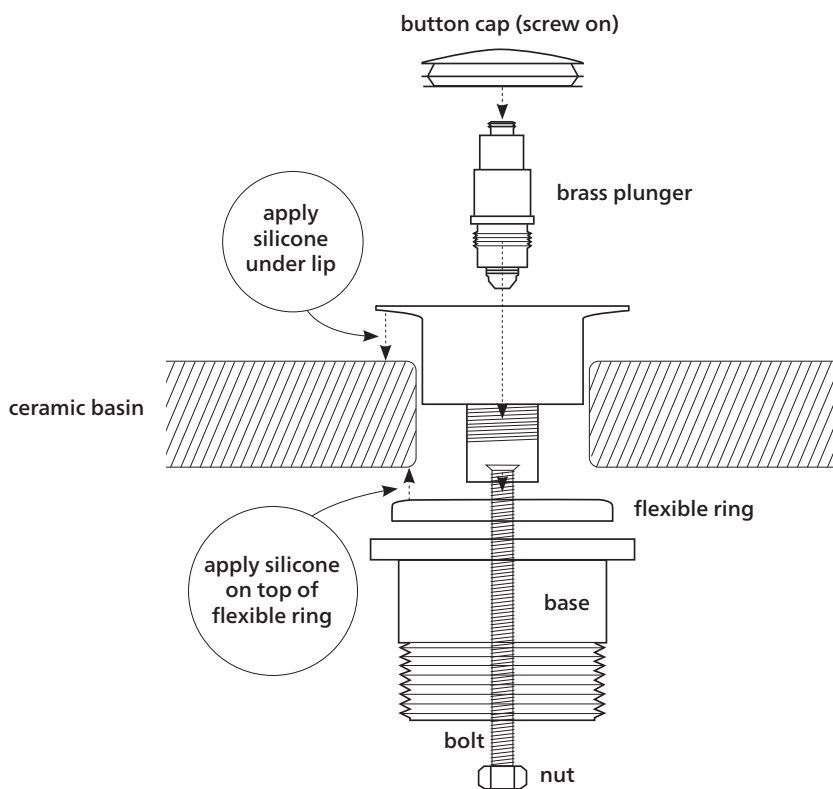

SEIMA

kitchen + laundry + bathroom ware

seima.com.au

Please note

- All measurements are in millimetres.
- Use silicone sealant. Do not use epoxy type adhesives.
- Specifications may vary without notice as part of our continuous improvement practices.
- Clean with a damp cloth. Do not use abrasive cleaners, liquids or pastes.

Bottle Trap

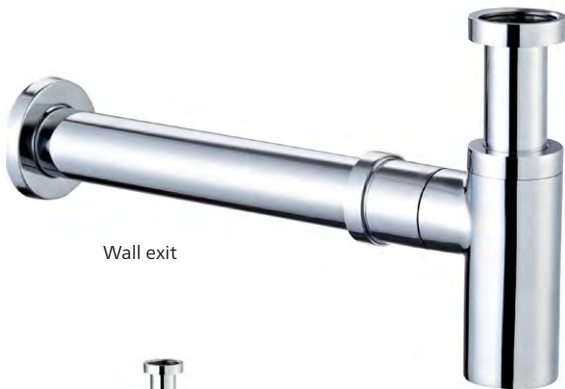
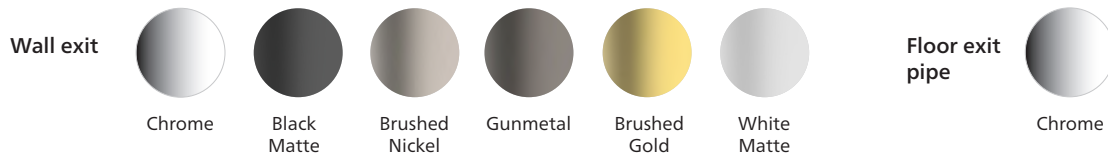

Wall exit

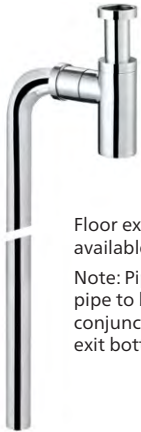

Floor exit pipe available in Chrome.
Note: Pipe only – pipe to be used in conjunction with wall exit bottle trap.

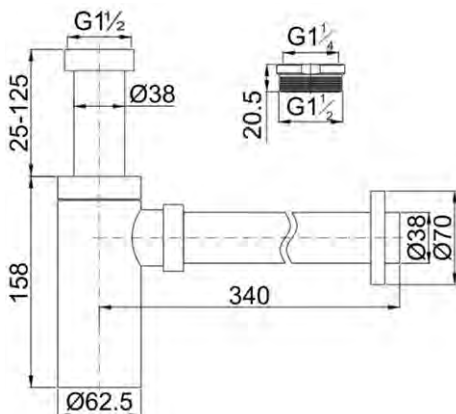

Bottle trap for wall basins and basins with exposed plumbing

- Wall exit available in multiple colours
- Floor exit available in Chrome only
- Solid brass base
- Suits 40 mm waste holes

Order codes

| WALL EXIT | |
|-----------|--|
| 191822 | Bottle trap, wall exit, Chrome |
| 192120 | Bottle trap, wall exit, Brushed Nickel |
| 192200 | Bottle trap, wall exit, Gunmetal |
| 192121 | Bottle trap, wall exit, Brushed Gold |
| 192122 | Bottle trap, wall exit, White Matte |
| 191836 | Bottle trap, wall exit, Black Matte |

| FLOOR EXIT – PIPE ONLY – CHROME | |
|---------------------------------|------------------------|
| 191824 | Chrome floor exit pipe |

Product details

| | |
|----------|---|
| WASTE | Suits 40 mm wastes. |
| FIXING | Must be fitted by a licensed plumber. Warranty does not cover any fault caused by installation or part installation by an unlicensed person. Ensure all o-rings are lubricated with silicone based lubricant. Fit connection pipe to plug and washer. Adjust trap height (trim connection pipe as required) to line up with wall outlet pipe and ensure there is a minimum 1.5 degree fall in the outlet pipe when installed. Measure and trim outlet pipe, ensuring there is adequate allowance for pipe and rubber seal to fit into DWV female socket. Fit rubber seal over outlet pipe and fit into 40mm DWV female socket. Fit protective cover over outlet pipe prior to final connection to plumbing. Firmly tighten all joints. Do not over-tighten. Test for leaks. |
| CLEANING | Clean with soapy water. Do not use corrosive or abrasive cleaners. |
| MATERIAL | Brass alloy base. |



SEIMA

kitchen + laundry + bathroom ware

seima.com.au

Please note

- All measurements are in millimetres.
- Use silicone sealant. Do not use epoxy type adhesives.
- Specifications may vary without notice as part of our continuous improvement practices.
- Clean with a damp cloth. Do not use abrasive cleaners, liquids or pastes.

Pop-out Bath Waste

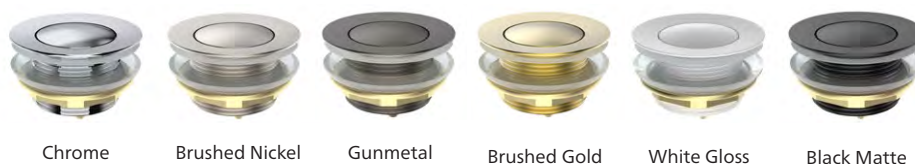

POP OUT bath waste



Innovative easy-to-remove pop-out design

Why pop-OUT?

The pop-out waste does exactly what its name suggests — the top section of the waste simply pops out (or pulls out). This patented innovation has significant advantages including:

- **REMOVABLE** The top of the waste is completely removable. Easy access, easy cleaning.
- **ANTI CLOG** The 'prongs' on the top section of the waste catch debris (including hair) as it flows into the waste. The streamlined simplicity of this design makes it easy to keep clear and clean.
- **ANTI SEIZE** The pop-out design eliminates the possibility of the plug seizing in the waste.
- **OPEN DESIGN** The openness of the design promotes efficient drainage.
- **PREMIUM QUALITY** Durable, high quality finish — all components are premium quality.
- **OVERFLOW OPTION** Available for overflow and non-overflow baths.
- 40 mm hole – standard size for bath wastes.
- Connects to Australian Standard pipework.
- Drains faster than a pop-up/-down waste.

Order codes

- SUIT ALL FLEXIWASTE KITS
- SUIT NON-OVERFLOW BATHS

| | |
|--------|---|
| 192014 | Seima Pop-out Bath Waste — Chrome |
| 192016 | Seima Pop-out Bath Waste — Brushed Nickel |
| 192201 | Seima Pop-out Bath Waste — Gunmetal |
| 192017 | Seima Pop-out Bath Waste — Brushed Gold |
| 192197 | Seima Pop-out Bath Waste — White Gloss |
| 192015 | Seima Pop-out Bath Waste — Black Silk Matte |

• SUIT BATHS WITH INTEGRATED OVERFLOW

| | |
|--------|---|
| 192023 | Seima Pop-out Bath Waste, overflow — Chrome |
| 192025 | Seima Pop-out Bath Waste, overflow — Brushed Nickel |
| 192202 | Seima Pop-out Bath Waste, overflow — Gunmetal |
| 192026 | Seima Pop-out Bath Waste, overflow — Brushed Gold |
| 192198 | Seima Pop-out Bath Waste, overflow — White Gloss |
| 192024 | Seima Pop-out Bath Waste, overflow — Black Silk Matte |

Product details

WASTE OUTLET Suits 40 mm waste holes.

FIXING Must be fitted by a licensed plumber. Warranty does not cover any fault caused by installation or part installation by an unlicensed person. Please refer to the diagram for installation guidelines. It is essential that the waste is sealed correctly using silicone where shown.

MATERIALS Solid brass base, plated/coated to achieve the colour finishes. The transparent flexible ring is premium quality.

CLEANING Clean with soapy water. Do not use corrosive or abrasive cleaners.



SEIMA

kitchen + laundry + bathroom ware

seima.com.au

Please note

- All measurements are in millimetres.
- Use silicone sealant. Do not use epoxy type adhesives.
- Specifications may vary without notice as part of our continuous improvement practices.
- Clean with a damp cloth. Do not use abrasive cleaners, liquids or pastes.

Bath Plug + Waste



Chrome waste + white rubber plug

- Durable, high quality finish.
- Chrome plated solid brass body and white rubber plug.
- Suits non-overflow baths and FlexiWaste kits.
- 40 mm hole – standard size for bath wastes.
- Connects to Australian Standard pipework.

Order code

192007 Bath waste and rubber plug (no overflow)

Product details

WASTE OUTLET Suits 40 mm waste holes.

FIXING Must be fitted by a licensed plumber. Warranty does not cover any fault caused by installation or part installation by an unlicensed person.

Please refer to the diagram for installation guidelines. It is essential that the waste is sealed correctly using silicone where shown.

MATERIALS Solid brass base with chrome finish. Rubber plug.

CLEANING Clean with soapy water. Do not use corrosive or abrasive cleaners.

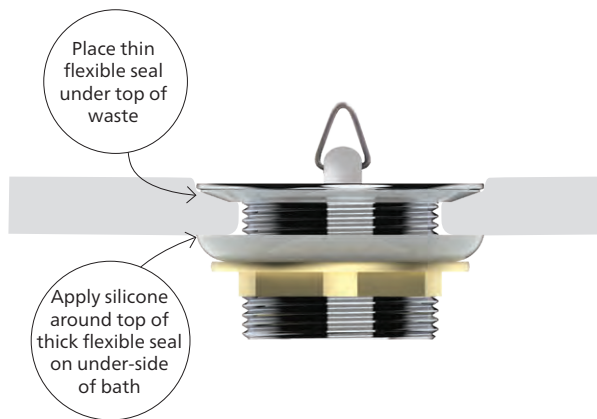

W
WaterMark
WMTS 040
LN 23422

SEIMA

kitchen + laundry + bathroom ware

seima.com.au

Please note

- All measurements are in millimetres.
- Use silicone sealant. Do not use epoxy type adhesives.
- Specifications may vary without notice as part of our continuous improvement practices.
- Clean with a damp cloth. Do not use abrasive cleaners, liquids or pastes.

FlexiWaste Bath Overflow Pop-out Kit

FlexiWaste

Bath Overflow Pop-out Kit

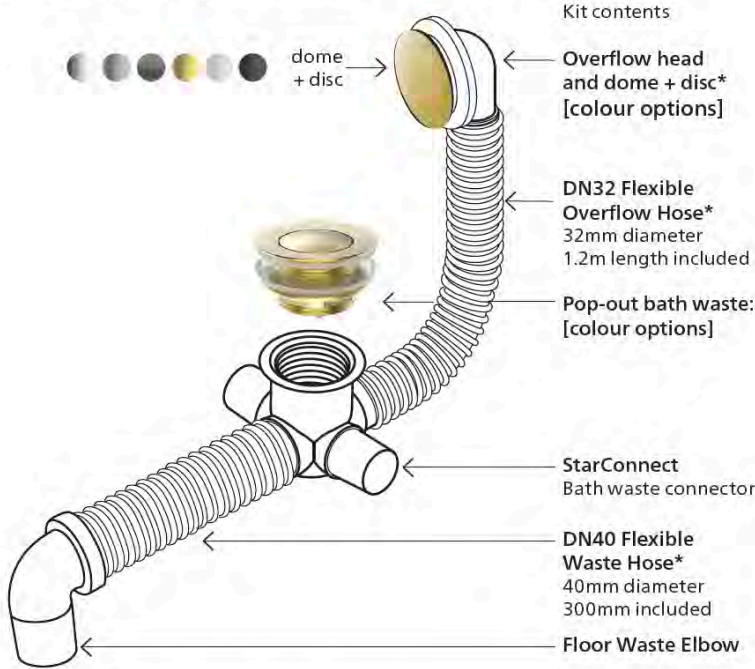

* Longer hose lengths available separately.
The overflow head comes with a chrome finish dome as standard. Colour dome and disc replace standard fittings.

FlexiWaste premium bath overflow kit

Kit includes

- Premium Pop-out Bath Waste – colour options
- Overflow dome – colour options
- Overflow kit

FlexiWaste offers a universal ultra-compact bath waste solution. The innovative StarConnect bath waste connector has an ultra-low 75mm profile under the bath, and multi-directional input and outlet options.

Order codes

| | |
|--------|--|
| 192235 | FlexiWaste Bath OF Pop-out Kit, Brushed Nickel |
| 192236 | FlexiWaste Bath OF Pop-out Kit, Black Silk Matte |
| 192237 | FlexiWaste Bath OF Pop-out Kit, White Gloss |
| 192238 | FlexiWaste Bath OF Pop-out Kit, Gunmetal |
| 192239 | FlexiWaste Bath OF Pop-out Kit, Brushed Gold |
| 192240 | FlexiWaste Bath OF Pop-out Kit, Chrome |

Optional extra hose – Spare parts

| | |
|--------|--|
| 192175 | DN40 Flexible waste hose, 300mm long |
| 192209 | DN40 Flexible waste hose, 500mm long |
| 192210 | DN40 Flexible waste hose, 1.0m long |
| 192176 | DN32 Flexible overflow hose, 1.2m long |
| 192208 | DN32 Flexible overflow hose, 2.0m long |

Product details

| | |
|--------------|--|
| MATERIALS | StarConnect connector, floor waste elbow – PVC. Waste – Metal. Flexible hose – Corrugated PVC. Overflow head – Metal (chrome finish), PVC, rubber seal. |
| INSTALLATION | Please refer to installation instructions. |
| CLEANING | Clean with soapy water. Do not use corrosive or abrasive cleaners. |

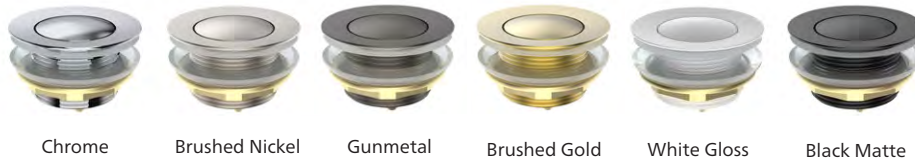

The StarConnect advantage

Ultra-compact bath waste connector

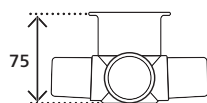

1 Ultra-low 75mm profile under bath

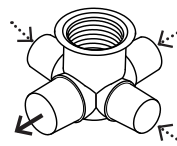

2 Multi-directional input + outlet options

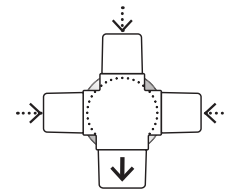

3 Knock-out openings on all three DN32 spigots



Designed and made in Australia by SEIMA.
This SEIMA innovation is a patented, registered design.

SEIMA

kitchen + laundry + bathroom ware

seima.com.au

Please note

- All measurements are in millimetres.
- Use silicone sealant. Do not use epoxy type adhesives.
- Specifications may vary without notice as part of our continuous improvement practices.
- Clean with a damp cloth. Do not use abrasive cleaners, liquids or pastes.

FlexiWaste Bath Overflow Kit Basic

FlexiWaste

Bath Overflow Kit Basic

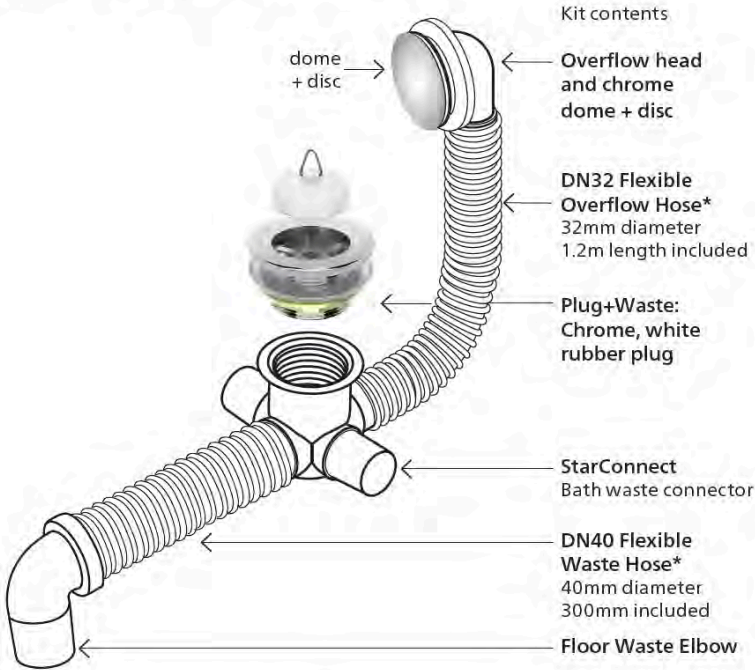

* Longer hose lengths available separately.

FlexiWaste basic bath overflow kit

Kit includes

- Plug+Waste, chrome, white rubber plug
- Overflow dome, chrome
- Overflow kit

FlexiWaste offers a universal ultra-compact bath waste solution. The innovative StarConnect bath waste connector has an ultra-low 75mm profile under the bath, and multi-directional input and outlet options.

Order code

192180 FlexiWaste Bath OF Kit – Basic, with Plug+Waste, chrome/white rubber

Optional extra hose – Spare parts

192175 DN40 Flexible waste hose, 300mm long
 192209 DN40 Flexible waste hose, 500mm long
 192210 DN40 Flexible waste hose, 1.0m long
 192176 DN32 Flexible overflow hose, 1.2m long
 192208 DN32 Flexible overflow hose, 2.0m long

Product details

MATERIALS StarConnect connector, floor waste elbow – PVC.
 Waste – Metal.
 Flexible hose – Corrugated PVC.
 Overflow head – Metal (chrome finish), PVC, rubber seal.

INSTALLATION Please refer to installation instructions.

CLEANING Clean with soapy water. Do not use corrosive or abrasive cleaners.

The StarConnect advantage

Ultra-compact bath waste connector

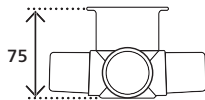

1 Ultra-low 75mm profile under bath

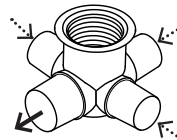

2 Multi-directional input + outlet options

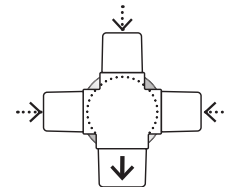

3 Knock-out openings on all three DN32 spigots



Designed and made in Australia by SEIMA.
 This SEIMA innovation is a patented, registered design.

SEIMA

kitchen + laundry + bathroom ware

seima.com.au

Please note

- All measurements are in millimetres.
- Use silicone sealant. Do not use epoxy type adhesives.
- Specifications may vary without notice as part of our continuous improvement practices.
- Clean with a damp cloth. Do not use abrasive cleaners, liquids or pastes.

FlexiWaste Bath Waste Pop-out Kit

FlexiWaste

Bath Waste Pop-out Kit



* Longer hose lengths available separately.

FlexiWaste premium bath waste kit Suits non-overflow baths

Kit includes

- Premium Pop-out Bath Waste – colour options
- FlexiWaste bath waste kit

FlexiWaste offers a universal ultra-compact bath waste solution. The innovative StarConnect bath waste connector has an ultra-low 75mm profile under the bath, and multi-directional input and outlet options.

Order codes

| | |
|--------|---|
| 192329 | FlexiWaste Bath Waste Pop-out Kit, Brushed Nickel |
| 192330 | FlexiWaste Bath Waste Pop-out Kit, Black Silk Matte |
| 192331 | FlexiWaste Bath Waste Pop-out Kit, White Gloss |
| 192332 | FlexiWaste Bath Waste Pop-out Kit, Gunmetal |
| 192333 | FlexiWaste Bath Waste Pop-out Kit, Brushed Gold |
| 192179 | FlexiWaste Bath Waste Pop-out Kit, Chrome |

Optional extra hose — Spare parts

| | |
|--------|--------------------------------------|
| 192175 | DN40 Flexible waste hose, 300mm long |
| 192209 | DN40 Flexible waste hose, 500mm long |
| 192210 | DN40 Flexible waste hose, 1.0m long |

Product details

MATERIALS StarConnect connector, floor waste elbow — PVC.
Waste — Metal.
Flexible hose — Corrugated PVC.

INSTALLATION Please refer to installation instructions.

CLEANING Clean with soapy water. Do not use corrosive or abrasive cleaners.

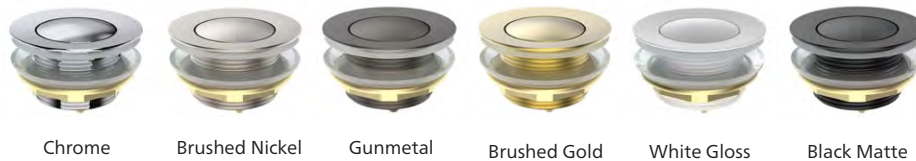

The StarConnect advantage

Ultra-compact bath waste connector

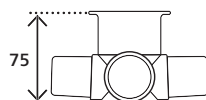

Ultra-low 75mm profile under bath

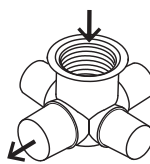

NOTE Only the DN40 Spigot is used in this FlexiWaste Bath Kit. (The three DN32 spigots are only needed for FlexiWaste Overflow Kits. Leave the DN32 spigots intact when using this kit.)



Designed and made in Australia by SEIMA.
This SEIMA innovation is a patented, registered design.

SEIMA

kitchen + laundry + bathroom ware

seima.com.au

Please note

- All measurements are in millimetres.
- Use silicone sealant. Do not use epoxy type adhesives.
- Specifications may vary without notice as part of our continuous improvement practices.
- Clean with a damp cloth. Do not use abrasive cleaners, liquids or pastes.

FlexiWaste Bath Waste Kit Basic

FlexiWaste

Bath Waste Kit Basic



FlexiWaste basic bath waste kit Suits non-overflow baths

Kit includes

- Plug+Waste, chrome, white rubber plug
- FlexiWaste bath waste kit

FlexiWaste offers a universal ultra-compact bath waste solution. The innovative StarConnect bath waste connector has an ultra-low 75mm profile under the bath, and multi-directional input and outlet options.

Order code

192178 FlexiWaste Bath Waste Kit Basic

Optional extra hose — Spare parts

192175 DN40 Flexible waste hose, 300mm long
 192209 DN40 Flexible waste hose, 500mm long
 192210 DN40 Flexible waste hose, 1.0m long

Product details

MATERIALS StarConnect connector, floor waste elbow — PVC.
 Waste — Metal.
 Flexible hose — Corrugated PVC.

INSTALLATION Please refer to installation instructions.

CLEANING Clean with soapy water. Do not use corrosive or abrasive cleaners.

The StarConnect advantage

Ultra-compact bath waste connector

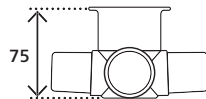

Ultra-low 75mm profile under bath

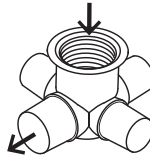

NOTE Only the DN40 Spigot is used in this FlexiWaste Bath Kit. (The three DN32 spigots are only needed for FlexiWaste Overflow Kits. Leave the DN32 spigots intact when using this kit.)



Designed and made in Australia by SEIMA.
 This SEIMA innovation is a patented, registered design.

SEIMA

kitchen + laundry + bathroom ware

seima.com.au

Please note

- All measurements are in millimetres.
- Use silicone sealant. Do not use epoxy type adhesives.
- Specifications may vary without notice as part of our continuous improvement practices.
- Clean with a damp cloth. Do not use abrasive cleaners, liquids or pastes.

Bath Waste Kits – Usage Guide

Options for *overflow* bath

Turn any non-overflow bath into an overflow bath with an overflow kit (with bath waste included).

There are two options:

- **PREMIUM OVERFLOW KIT**
This includes a premium colour Pop-out Bath Waste and colour overflow dome.
- **BASIC OVERFLOW KIT**
This includes a chrome plug and waste and chrome overflow dome.

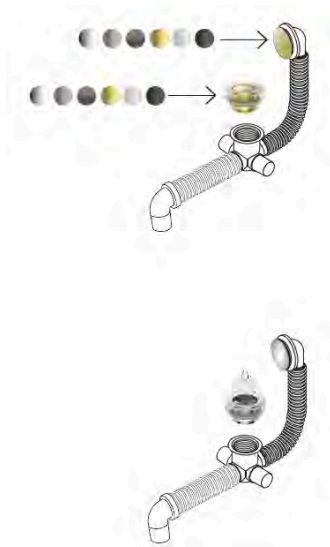

PREMIUM OVERFLOW KIT

FlexiWaste Bath Waste Overflow Pop-out Kit

- includes premium Pop-out Bath Waste – colour options
- includes Overflow Dome – colour options

Order codes

| | |
|--------|--|
| 192235 | FlexiWaste Bath OF Pop-out Kit, Brushed Nickel |
| 192236 | FlexiWaste Bath OF Pop-out Kit, Black Silk Matte |
| 192237 | FlexiWaste Bath OF Pop-out Kit, White Gloss |
| 192238 | FlexiWaste Bath OF Pop-out Kit, Gunmetal |
| 192239 | FlexiWaste Bath OF Pop-out Kit, Brushed Gold |
| 192240 | FlexiWaste Bath OF Pop-out Kit, Chrome |

BASIC OVERFLOW KIT

FlexiWaste Bath Waste Overflow Kit Basic

- includes Chrome Plug+Waste, white rubber plug
- includes overflow dome – Chrome

Order code

| | |
|--------|--|
| 192180 | FlexiWaste Bath OF Kit Basic – Chrome Plug+Waste |
|--------|--|

Options for *non-overflow* bath

Baths without overflow need a bath waste kit and bath waste.

There are two options:

- **PREMIUM WASTE KIT**
This includes a premium colour Pop-out Bath Waste.
- **BASIC WASTE KIT**
This includes a chrome plug and waste.

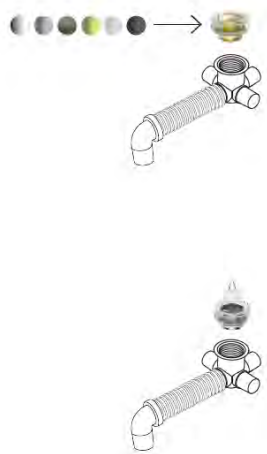

PREMIUM WASTE KIT

FlexiWaste Bath Waste Pop-out Kit

- includes premium Pop-out Bath Waste – colour options

Order codes

| | |
|--------|---|
| 192329 | FlexiWaste Bath Waste Pop-out Kit, Brushed Nickel |
| 192330 | FlexiWaste Bath Waste Pop-out Kit, Black Silk Matte |
| 192331 | FlexiWaste Bath Waste Pop-out Kit, White Gloss |
| 192332 | FlexiWaste Bath Waste Pop-out Kit, Gunmetal |
| 192333 | FlexiWaste Bath Waste Pop-out Kit, Brushed Gold |
| 192179 | FlexiWaste Bath Waste Pop-out Kit, Chrome |

BASIC WASTE KIT

FlexiWaste Bath Waste Kit Basic

- includes Chrome Plug+Waste, white rubber plug

| | |
|--------|---|
| 192178 | FlexiWaste Bath Kit, with Plug+Waste, chrome/white rubber |
|--------|---|

Options for baths with *integrated overflow*

Baths with an integrated overflow need a bath waste kit and bath waste suitable for integrated overflow.

You will need the following:

- **PREMIUM WASTE KIT**
This includes a premium colour Pop-out Bath Waste.

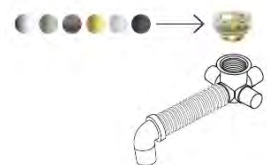

PREMIUM WASTE KIT

FlexiWaste Bath Waste Pop-out Kit

- includes premium Pop-out Bath Waste – colour options

Order codes

| | |
|--------|---|
| 192329 | FlexiWaste Bath Waste Pop-out Kit, Brushed Nickel |
| 192330 | FlexiWaste Bath Waste Pop-out Kit, Black Silk Matte |
| 192331 | FlexiWaste Bath Waste Pop-out Kit, White Gloss |
| 192332 | FlexiWaste Bath Waste Pop-out Kit, Gunmetal |
| 192333 | FlexiWaste Bath Waste Pop-out Kit, Brushed Gold |
| 192179 | FlexiWaste Bath Waste Pop-out Kit, Chrome |

SEIMA

kitchen + laundry + bathroom ware

seima.com.au

Please note

- All measurements are in millimetres.
- Use silicone sealant. Do not use epoxy type adhesives.
- Specifications may vary without notice as part of our continuous improvement practices.
- Clean with a damp cloth. Do not use abrasive cleaners, liquids or pastes.